

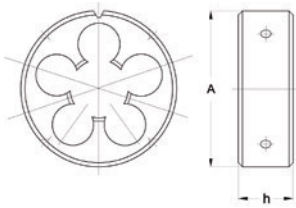

Whitworth-Gewinde nach DIN 11 (BSW)
Whitworth-Thread acc. to DIN 11 (BSW)

EN 22568

T1030			1503		
TOPSELL			UNI		
		HSS			HSS
	Oil	blank bright		Oil	blank bright
	1,5 - 2 x P	Form B		1,5 - 2 x P	



A mm	h mm	W mm	D Zoll / inch	P Gangzahl	CODE	EUR	CODE	EUR
16	5	1,55	W 1/16"	60			103000009060012	35,70
16	5	2,30	W 3/32"	48			103000009060016	31,80
20	5	3,09	W 1/8"	40	853000009000020	16,50	103000009060020	24,20
20	5	3,88	W 5/32"	32	853000009000025	15,90	103000009060025	23,80
20	7	4,16	W 3/16"	24	853000009000035	15,90	103000009060035	23,80
20	7	5,43	W 7/32"	24	853000009000060	15,90	103000009060060	23,80
20	7	6,17	W 1/4"	20	853000009000160	15,90	103000009060160	23,80
25	9	7,76	W 5/16"	18	853000009000220	15,90	103000009060220	23,80
30	11	9,30	W 3/8"	16	853000009000300	19,60	103000009060300	29,40
30	11	10,90	W 7/16"	14	853000009000420	25,60	103000009060420	36,00
38	14	12,44	W 1/2"	12	853000009000560	31,00	103000009060560	46,50
38	14	14,02	W 9/16"	12	853000009000720	31,40	103000009060720	47,20
45	18	15,62	W 5/8"	11	853000009000840	41,20	103000009060840	61,80
45	18	18,76	W 3/4"	10	853000009002130	43,60	103000009062130	65,40
55	22	21,90	W 7/8"	9	853000009002280	65,00	103000009062280	97,00
55	22	25,08	W 1"	8	853000009002400	67,00	103000009062400	116,00
65	25	28,11	W 1 1/8"	7			103000009062580	121,00
65	25	31,35	W 1 1/4"	7			103000009062760	121,00
65	25	34,49	W 1 3/8"	6			103000009062940	123,00
75	30	37,67	W 1 1/2"	6			103000009063090	176,00